

C944	P/N 36745	REV. G
DRAWN BY: GRANADOSIN	DATE: 05.21.02	SHEET 1 OF 5

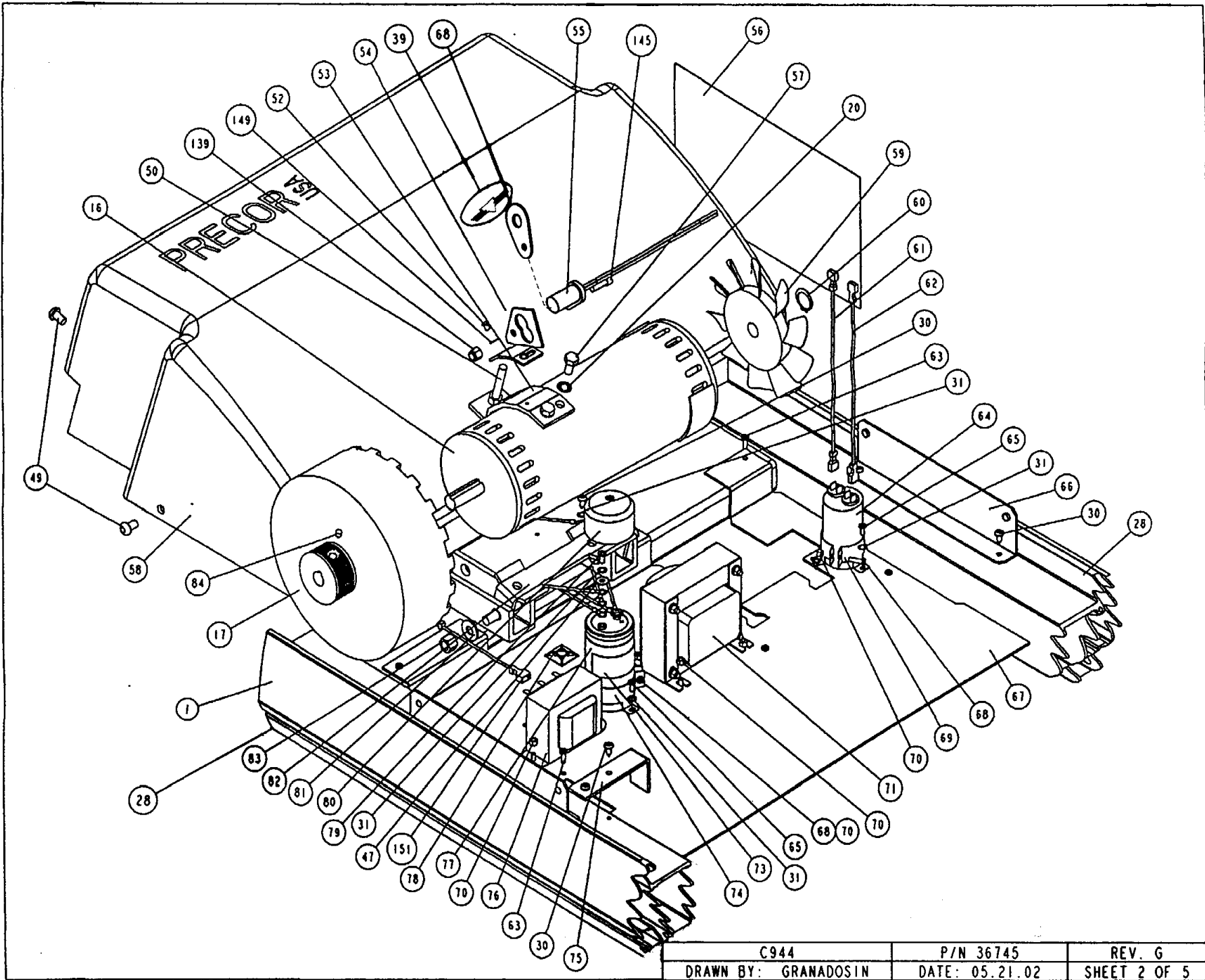

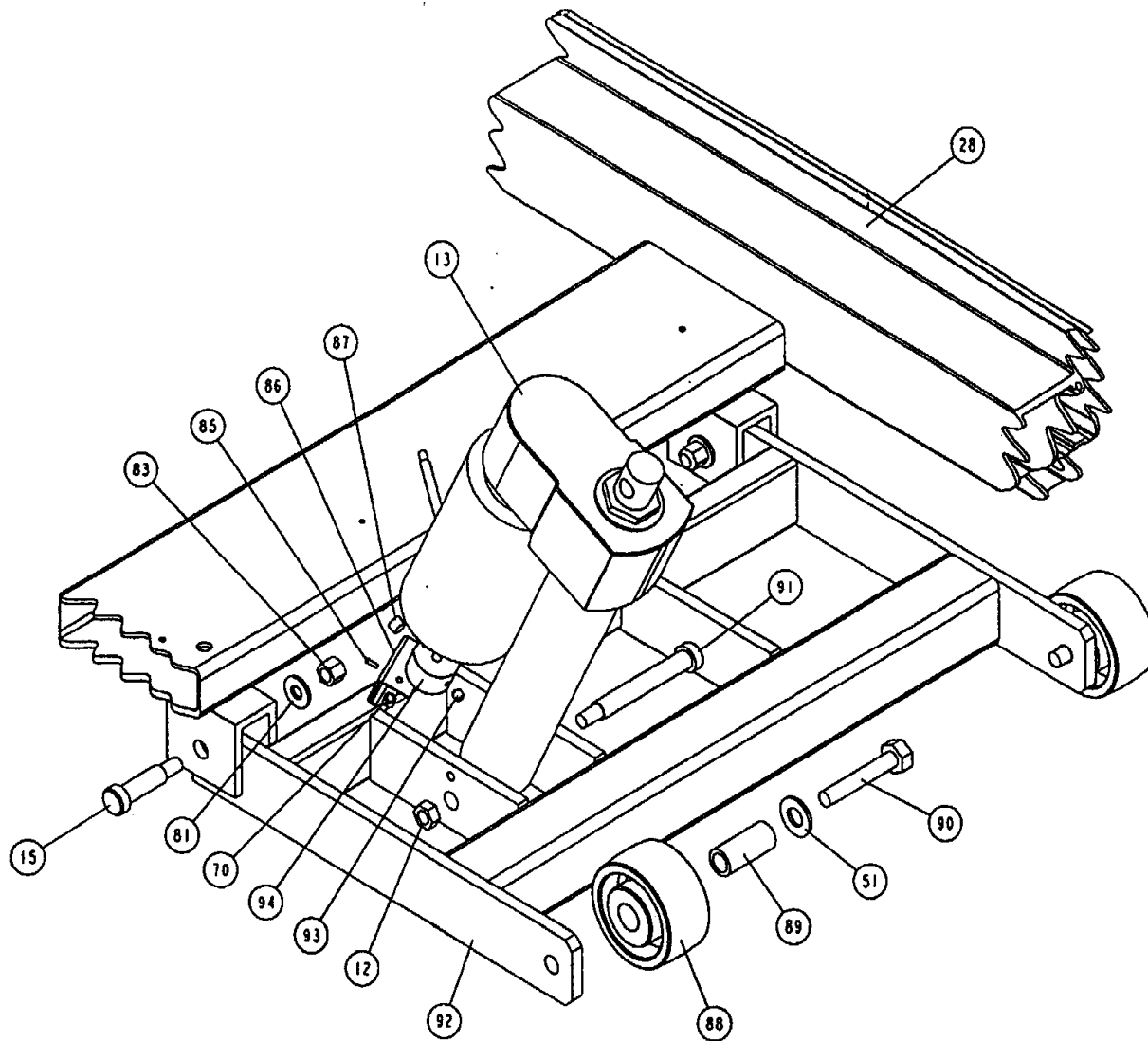

C944	P/N 36745	REV. G
DRAWN BY: GRANADOSIN	DATE: 05.21.02	SHEET 3 OF 5

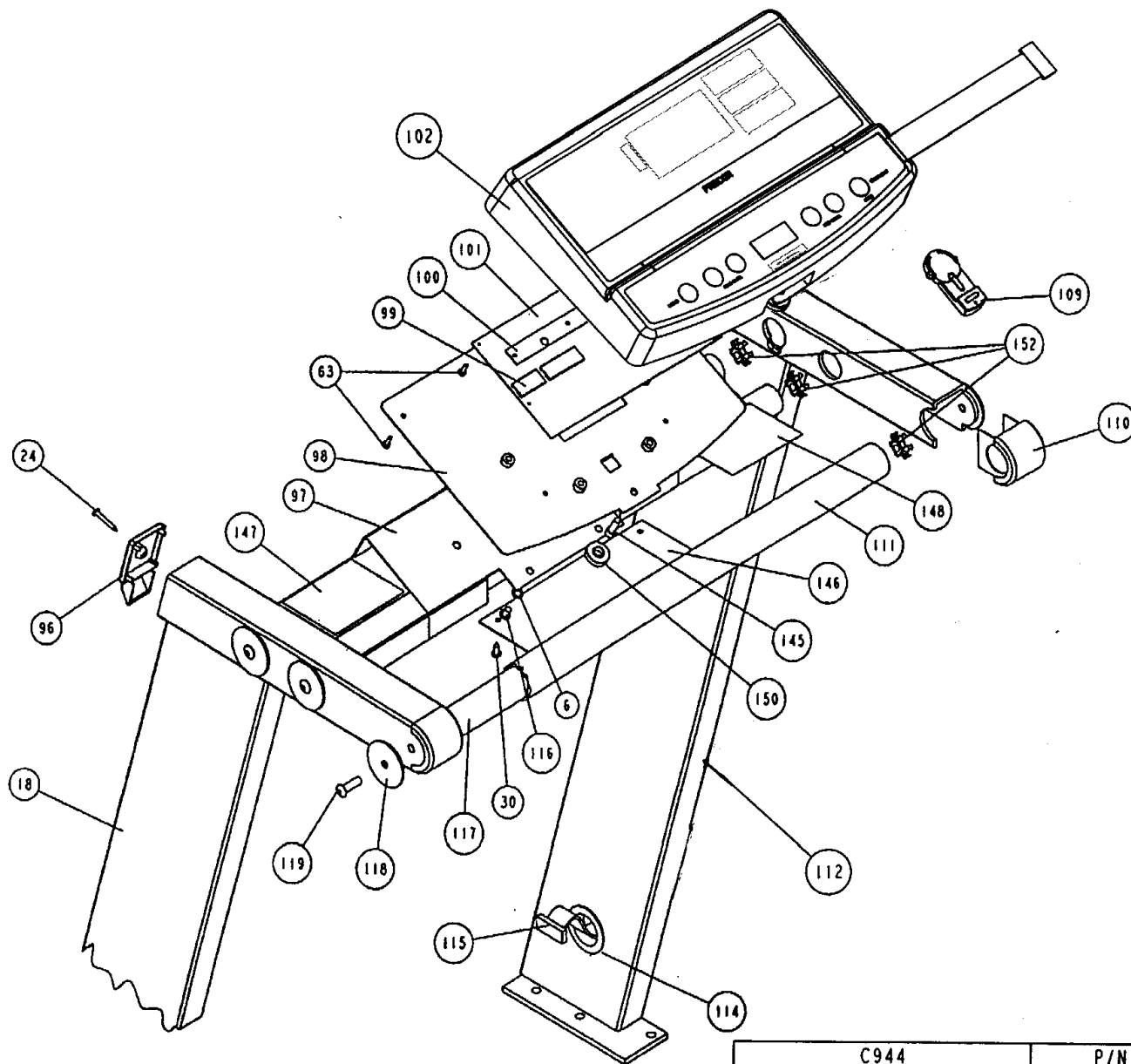

C944	P/N 36745	REV. G
DRAWN BY: GRANADOSIN	DATE: 05.21.02	SHEET 4 OF 5

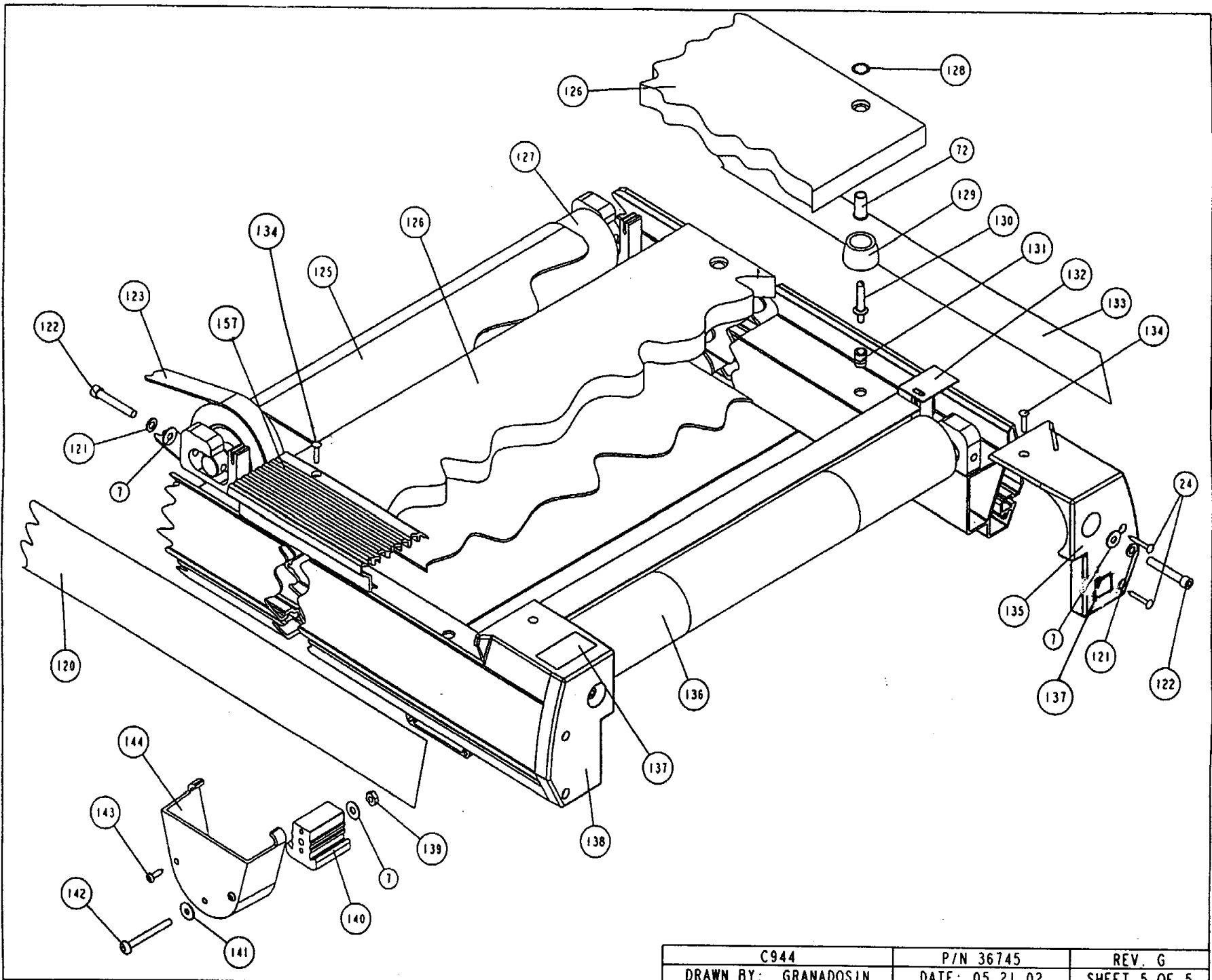

C944	P/N 36745	REV. G
DRAWN BY: GRANADOSIN	DATE: 05.21.02	SHEET 5 OF 5

C944 (120 VAC, version 1) (serial code E5)

Part Number	Description	Bubble Number
33932-101	BLOCK, ACTUATOR	2
RANE025-150	SCR,SHLD,1/4X20 X1-1/2 ,HEXSC	3
33934-104	SHAFT, ACTUATOR, FINISH C960	4
CAKN025-038	SCREW,SKHD,1/4-20X3/8,BLK ZN,LK	5
WATNN025-003	WASHER, LK-INT, ID=.25,	6
WCCN025-007	WASHER, FLT, 1/4X.734X.065	7
10741-101	SWITCH,LIMIT,	8
MGCE011-075	SCREW,MCH,4-40X3/4,PANHD,PHIL,	9
CAKN013-050	SCREW,SKHD,6-32X0.50,BLK ZN,LK	11
KGCN038-033	LOCKNUT, STARWASHER, 3/8-16	12
33658-106	MOTOR,LIFT,120V,C94X ONLY	13
RCNN038-400	SCREW,SHLD,1/2 X 4 ,HEXSC,	14
RANN038-150	SCR,SHLD,1/2 X 1-1/2 ,HEXSC	15
36615-101	MOTOR,DRIVE,90VDC,2HP,18AMPS	16
36593-101	FLYWHEEL	17
36553-106	WELDMENT, TARGA, LEFT, PWM,	18
59035-101	C94X & 9.4X SILVER TARGA RETRO KIT	18.01
36415-102	PLATE, STUDED, TARGA	23
PGKN016-125	SCREW,S/T,#8X1-1/4,TRS,PHIL,	24
32062-101	LABEL, CAUTION, RISK OF FIRE	29
10006-127	SCREW,S/T,#10X1/2,PANHD,PHIL,	30
WATNN020-002	WASHER, LK-INT, #10, ID=.200,	31
36166-101	SHIELD, POWER C960	32
10435-101	CKT BRKR,250V,MAGNETIC,ROCKER,	34
10237-102	LOCKNUT,1-19/64 X 9/32 ,NYLON	35
MGKN011-025	SCREW,MCH,4-40X1/4,PANHD,PHIL,	36
33666-102	ASSY, ELEC.MODULE,LOWER C944, SCR	40
37172-102	ASSY, CABLE, LIFT SENSOR	44
10123-102	CABLE TIE, 3-7/8 LONG,WHITE,NYL	46
WACN019-005	WASHER, FLT, #10X.500X.049,ZN	47
10857-110	DIODE BRIDGE/SCR MODEUL,42.5A	48
TAKN031-050	SCREW,BTHD,5/16-18X1/2,BLK ZN	49
BNCN031-350	J-BOLT, HOOK, 5/16-18X3.5,ZN	50
WBCN050-010	WASHER, FLT, 1/2, ID=.531,	51
MHCN019-025	SCREW,MCH,10-32X1/4,PANHD,PHIL	52
38940-101	BRACKET,HALL EFFECT SENSOR	54
59011-105	ASSY, SPEED SENSOR, 120V LARGE	55
HDCN031-063	SCREW,HEX,GR 5,5/16-24X5/8,ZN	57
37621-101	LABEL,GROUND EFFECTS,OVAL,DURO-LENZ	58
50974-103	ASSY, HOOD W/LABELS, M9.45,	58
32560-101	FAN, MOTOR	59
10133-102	RING,RETAINER,3/4,EXT	60
10775-103	CAP,MOTOR RUN,25UF,370VAC	64
MGCN016-038	SCREW,MCH,8-32X3/8,PANHD,PHIL,	65
36548-101	BRACKET, HOOD MOUNTING	66
MGCN016-063	SCREW,MCH,8-32X5/8,PANHD,PHIL,	68
10036-104	CLAMP,CAPACITOR,1.75 DIA	69
KGCN016-013	LOCKNUT, STARWASHER 8-32, HEX	70
31551-103	INDUCTOR, 6.7MH, 3A, W/LEADS,	71

37033-101	BUSHING, SOFT DECK	72
33272-101	LABEL, CAPACITOR DISCHARGE	73
10036-101	CLAMP,CAPACITOR,2.0 NOM	74
10766-101	XFORMER,120/220VAC,28VCT,3.6A	76
10035-108	CAP,AL-E,2200UF,200V,2.02 X3.69	77
10332-101	MOUNT, CABLE TIE	78
MHCN019-038	SCREW,MCH,10-32X3/8,PANHD,PHIL	79
10479-101	CAPACITOR CAP,2 OD X 1 HIGH	80
WCCN031-008	WASHER, FLT, 5/16X.875X.083	81
36618-103	BRACKET, MOTOR PIVOT, PLATED	82
KDCN038-025	LOCKNUT, FULL, 3/8-16, ZINC	83
MGCN011-019	SCREW,MCH,4-40X3/16,PANHD,PHIL	85
33702-101	BRACKET, SENSOR	86
10650-102	MAGNET,0.365 D X 0.25	87
36192-101	BUSHING, SPANNER	89
HCKN050-250	SCREW,HEX,GR 5,1/2-13X2-1/2,BLK ZN	90
RCNN038-325	SCR,SHLD,1/2 X 3-1/4 ,HEXSC,	91
EKKN025-025	SCREW,SET,1/4-20X1/4,KNRLDCUP,	93
33703-102	BRACKET, LIMIT SWITCH	95
59008-101	KIT, LIFT REVOLUTION SENSOR	95
36511-101	ENDCAP, TARGA	96
36600-201	WELDMENT, TARGA CROSSMEMBER,PT	97
36614-107	PROM,C944(SCR),UPR,V1.06	99
36460-102	PCA, DISPLAY, M9.25, M9.45,	101
59010-106	ASSY,DISPLAY,ENGLISH,C944	102
36566-105	ASSY, FAILSAFE CORD,NEW CLIP	109
36553-102	WELDMENT, TARGA, RIGHT, PAINT	112
10178-103	BUSHING, SNAP, 2300	114
33432-106	ASSY, RIBBON CABLE	115
TAKN025-038	SCREW,BTHD,1/4-20X3/8,BLK ZN	116
59019-101	ASSY,HANDRAIL	117
TAKE031-125	SCREW,BTHD,5/16-18X1-1/4,BLK ZN	119
WMSN033-006	WASHER, AN960-516, ID=.328,	121
CAKN031-200	SCREW,SKHD,5/16-18X2,BLK ZN,LK	122
10217-103	BELT, DRIVE, 280J10 POLY V	123
HCCN031-100	SCREW, HEX, GR 5, 5/16-18 X 1.0, ZN	124
50987-101	ASSY,BED,944/940,SHORT	126
37577-101	ASSY, DRIVE ROLLER	127
33563-102	SPRING, BED SUPPORT	129
36118-103	STUD, BED, HEX DRIVE	130
10546-102	NUTSERT, 5/16-18	131
36549-501	GUARD, FINGER, REAR, PAINTED	132
DCKN019-100	SCREW,WOOD #10X1, L=1.00	134
36409-101	ENDCAP, RIGHT	135
31825-102	ASSY, TAKE-UP ROLLER,	136
36409-102	ENDCAP, LEFT	138
KDKN025-023	LOCKNUT, FULL, 1/4-20, BLK ZN	139
36382-103	FOOT, C960	140
WCKN025-007	WASHER, PLAIN 1/4 BLACK	141
TAKN025-250	SCREW,BTHD,1/4-20X2-1/2,BLK ZN	142
PBKN019-075	SCREW,S/T,#10X3/4,PANHD,PHIL,	143

33566-102	CAP, END, REAR CROSS	144
59006-101	ASSY, REAR FOOT C960	144.01
37245-501	PLATE, TARGA SHIELD, PAINTED	146
36705-103	LABEL, DISPLAY CAUTION C944	147
36703-103	LABEL, COURSES C944 ENGLISH	148
WAMCN019-002	WASHER, LOCK, EXT TOOTH, #10	149
37327-101	ASSY, JUMPER CABLE	151
10385-106	CONNECTOR, TUBE, 5/16-18, 1.25	152
MHKN019-038	SCREW,MCH,10-32X3/8,PANHD,PHIL	156
36620-105	KIT, HARDWARE, C944, M9.41S	201
36747-102	SHIPPER, TARGA INSERT	207
36748-102	SHIPPER, TOP END	208
36749-102	SHIPPER, BTM END SCORED PAD	209
36750-103	SHIPPER, TOP END SCORED PAD	210
36751-103	SHIPPER, OUTER BOTTOM	211
36752-104	SHIPPER, OUTER TOP	212
50973-104	ASSY, SHIPPER, M9.45, C944,	214
36678-107	SHIPPER, FOAM BLOCK, LEFT	215
36678-108	SHIPPER, FOAM BLOCK, RIGHT	216
10186-103	WRENCH, ALLEN, 3/16	273
20002-107	BRUSH, MOTOR (YP00503)	990
36621-104	KIT, LITERATURE, C944	999